



DELONIX
— HOMES —

Introducing **THE CYPRESS** signature design

This 1231 sf rancher is big on character with its Craftsmen exterior and natural wood, but even bigger on versatility with its fully developed basement generating 2400 sf. With a narrow footprint, The Cypress is perfect for infill and narrow lots. Features include well positioned bedrooms main floor laundry and stunning architectural ceilings. The Cypress delivers style and functionality with dedicated areas for custom build ins such as bookshelves, desks and benches. The Cypress can be built with a rear detached garage.

The Cypress is a two-time Canadian Home Builders top five home.

To learn how The Cypress can be personalized to fit your life please contact us.

OUR SIGNATURE HOMES

Delonix Homes has created a series of signature floor plans designed to inspire you.

Each of our plans feature the best of curb appeal, functionality and natural light. Our homes have been carefully planned with distinct entry, living and sleeping spaces, large kitchens and dining areas, beautiful sight lines, luxurious bathrooms, and utility zones that offer storage solutions for life's clutter.

Every home should tell the story of the family that lives there. Our build starts with getting to know you and understanding your style. Choose one of our thoughtfully designed signature plans and personalize it by selecting your preferred layout and exterior. We'll incorporate best practices in energy efficiency and construction techniques, and help you select your interior features and finishes from a carefully edited menu to create a home that feels timeless and fresh.

Floor Plan

Main floor: 1231 sf



Second floor: 1212sf

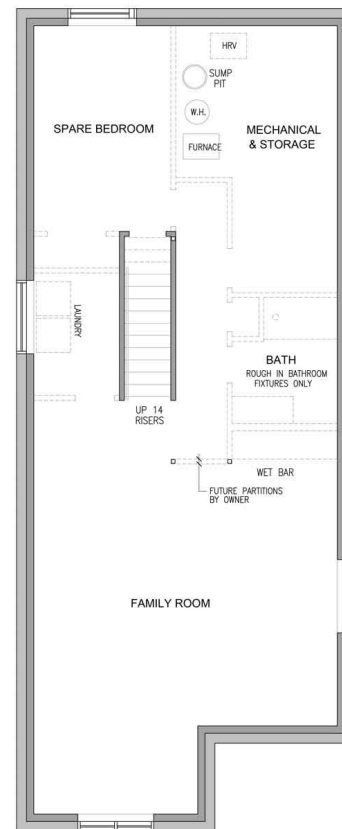



Exterior



DELONIX
— HOMES —